

**FOR INFORMATION ONLY  
NOT FOR MANUFACTURING  
PURPOSES**

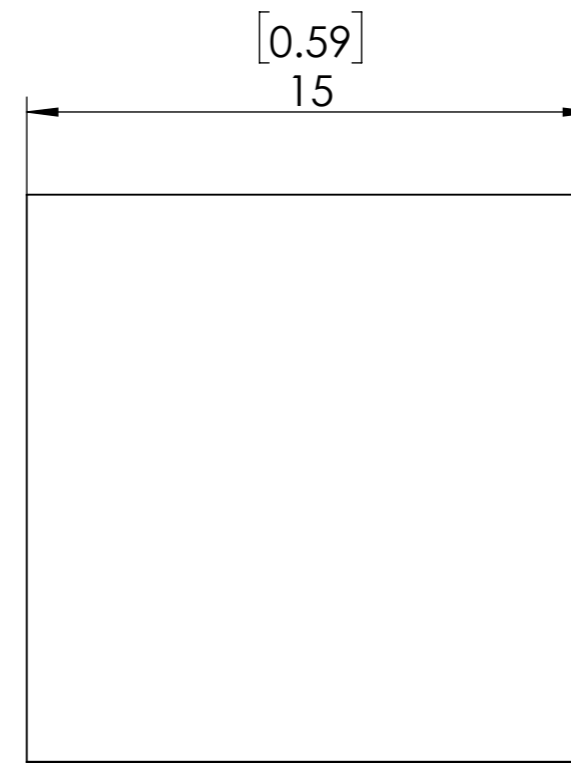
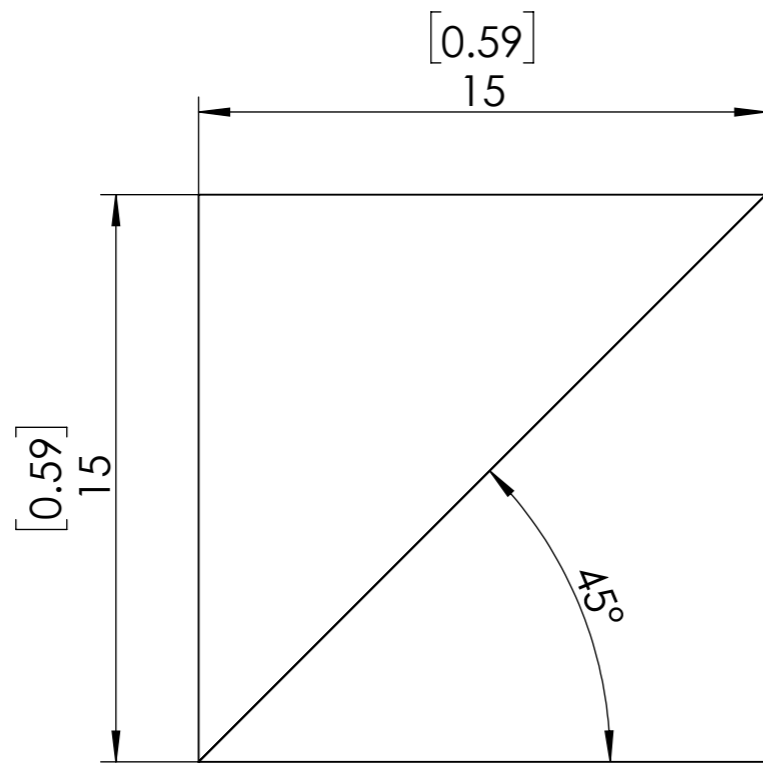
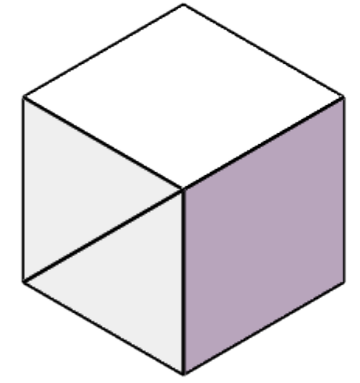

1. CLEAR APERTURE: >90%
2. SURFACE FLATNESS: < $\lambda/4$ @633nm
3. SURFACE QUALITY: 40-20
4. AOI: 0 deg
5. SPLIT RATIO: 50:50%
6. POLARIZATION:  $T=(T_s+T_p)/2$   $R=(R_s+R_p)/2$
7. TRANSMITTED BEAM DEVIATION: <3 arcmin
8. REFLECTED BEAM DEVIATION: <3 arcmin
9. DIMENSION TOLERANCE:  $\pm 0.2$  mm
10. T/R TOLERANCE:  $\pm 5\%$ ,  $T=(T_s+T_p)/2$ ,  $R=(R_s+R_p)/2$
11. COATING:  $R_{avg} < 0.5\%$  @ 900-1200nm

<b>SIMTRUM</b> <a href="http://www.simtrum.com">www.simtrum.com</a>	
Title:	Polarization dependent beamsplitter cubes
Material:	BK7
Part No:	BK7-BSC-15-900-1200